

Published : Apr 21, 2004

## Valve Cover LH (12.29.43)

### Removal

- 1 . Disconnect the battery ground cable. For additional information, refer to [Specifications](#) (Section 414-00)
- 2 . Remove the ignition coil-on-plug. For additional information, refer to [Ignition Coil-On-Plug \(18.20.44\)](#) (Section 303-07)
- 3 . Remove the remaining ignition coil-on-plugs.
- 4 . Remove the oil level indicator and tube.
  - Remove the dipstick.
  - Remove the nut.
  - Discard the O-ring seal.

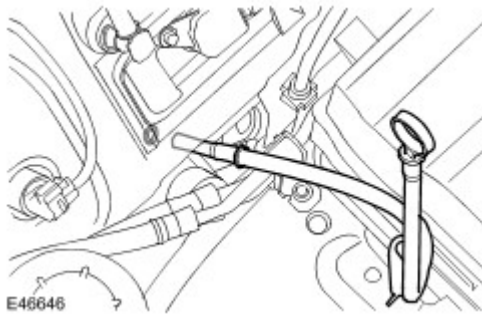

- 5 . Release the engine wiring harness from the retaining bracket.

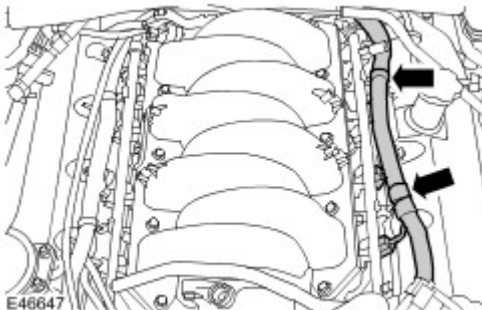

- 6 . Disconnect the variable camshaft timing ( VCT) oil solenoid electrical connector.
- 7 . Disconnect the valve cover breather hose.

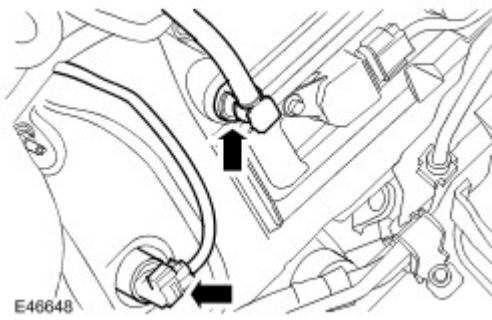

8. **NOTE :**  
Note the fitted position of the retaining bolts prior to removal.  
Remove the valve cover assembly.
- ▶ Remove the 14 valve cover retaining bolts.

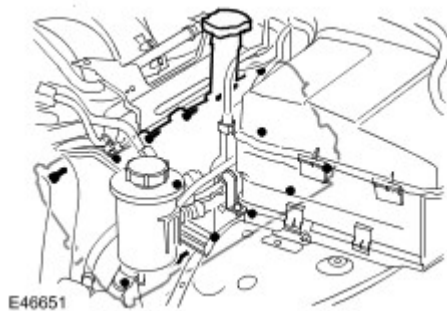

9. Remove and discard the valve cover gaskets.

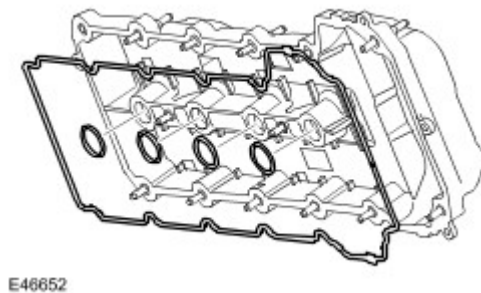

10. **NOTE :**  
Do not disassemble further if the component is removed for access only.  
Remove the oil filler tube.
- ▶ Remove and discard the O-ring seal.

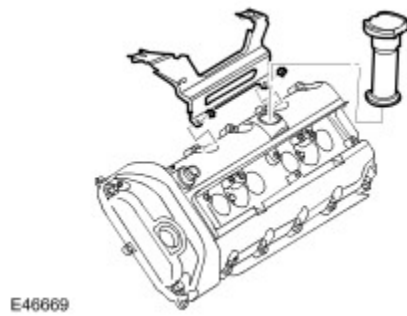

## Installation

- 1 . Install the oil filler tube.
  - Install a new O-ring seal.
- 2 . Install new valve cover plug aperture seals
- 3 . Install a new valve cover gasket.
- 4 . **NOTE :**

Apply two beads of silicone gasket sealant as shown on the illustration. The application of the sealant must be 3mm diameter 12mm long. Install the valve cover immediately after applying the sealant. The cover should be fitted directly to the head without smearing the sealant or the seals.

Install the valve cover.

  - Clean the component mating faces.

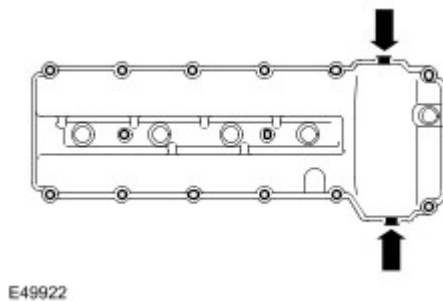

- 5 . Install the valve cover retaining bolts.
  - Install valve cover retaining bolts to their position previously noted.
  - Complete the tightening sequence as illustrated.
  - Tighten the bolts to 12 Nm (9 lb.ft).

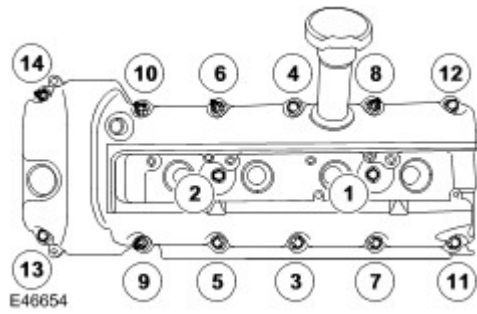

- 6 . Connect the VCT oil solenoid electrical connector.
- 7 . Attach the engine wiring harness to the retaining bracket.
- 8 . With assistance, install the oil level indicator and tube.
  - Clean the component mating faces.
  - Install a new O-ring seal.
  - Lubricate the seal with clean engine oil.
  - Tighten the nut to 6 Nm (4 lb.ft).
- 9 . Install the ignition coil-on-plug. For additional information, refer to [Ignition Coil-On-Plug \(18.20.44\)](#) (Section 303-07)
- 10 . Install the remaining ignition coil-on-plugs.